

MTWH / MTH MULTIJET FLOWMETERS

- Multi-jet turbine meter.
- Operating temperature up to 130 °C.
- High sensitiveness (starting flow) guarantees the accuracy at very small flow rates.
- Quality norms
ISO 9001/EN 29001.
- - Conforms to O.I.M.L.
R72/R75 and EN 1434.
- Approved in all European countries : Germany (P.T.B.), France (DRIRE), Sweden (S.P.), Poland, CIS, etc.



PRODUCT RANGE

TYPE	Temperature range	Maximum accidental temp.	Installation	Pressure
MTWH*	0 - 110 °C	0 - 120 °C	horizontal	PN 16
MTH	0 - 130 °C	0 - 140 °C	horizontal	PN 16 or PN 25

* On request vertical version (MTWH-V)

METROLOGICAL CHARACTERISTICS

Nominal diameter DN (mm)	Nominal flow Qn (m³/h)	Starting flow (m³/h)	Minimum flow Qmin (m³/h)	Transition flow Qt (m³/h)	Maximum variable flow Qmaxv** (m³/h)	Maximum flow Qmax* (m³/h)	Head loss at 2/3 Qn (mbar)	Pulse value (liter)
20	2,5	0,02	0,05	0,2	3	5	0,1	10
25	3,5	0,03	0,07	0,28	4,5	7	0,1	10
32	6	0,03	0,12	0,48	7	12	0,1	10
40	10	0,06	0,20	0,80	12	20	0,1	10

* short time

** a few days per year, obtained during the coldest days of the year



MTWH



MTH

HEAD LOSS

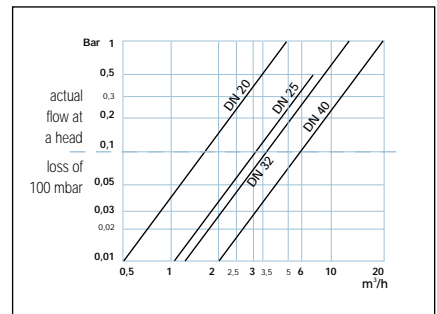

TECHNICAL CHARACTERISTICS

Nominal flow	Qn m³/h	2,5	3,5	6	10
Nominal diameter	DN mm	20	25	32	40
Length without screw couplings	A mm	190	260	260	300
Threads on connections	inch	G1B	G11/4B	G11/2B	G2B
Length with screw couplings	B mm	285	375	375	440
Threads on screw couplings	inch	G3/4B	G1B	G11/4B	G11/2B
Length with flanges*	A mm	190	260	260	300
Height from pipe centerline (up)	H mm	68	74	74	96
Height from pipe centerline (down)	h mm	41	43	44	44
Height of meter (with flanges)	G mm	116	124	135	156
Weight with screw couplings	kg	2,2	3,5	3,8	7,2
Weight with flanges*	kg	3,6	4,6	5	9,8

* Only for MTH.

DIMENSIONS

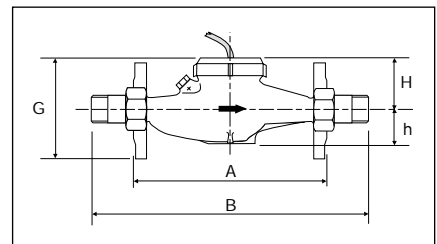

RECOMMENDATIONS OF USE

The meter must be protected upstream by a filter specially if the water is highly dirty or untreated. The minimum temperature of the water has to exceed 0 °C.

For more information, see www.actaris.com