

# Industrial Gas Meter G25

## Exact measurement and security



### Overview

The gas meter G25 is designed for measurement of gas supplied to industrial plants where maximum consumption of gas is equivalent to 40m<sup>3</sup>/h of air of density of 1,2 kg/m<sup>3</sup> and the ambient temperature remains between -25°C and +55°C.

Gas meter can be equipped with pulse generator (1 imp = 0,1m<sup>3</sup>) and then the gas meter is marked G25N

The gas meters can be used for measurement of:

- Natural gas
- City gas
- Propane-butane gas

### Typical error curves

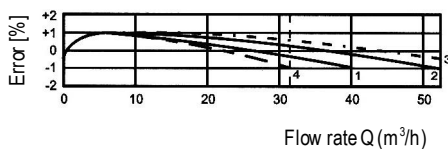

### Dimensions

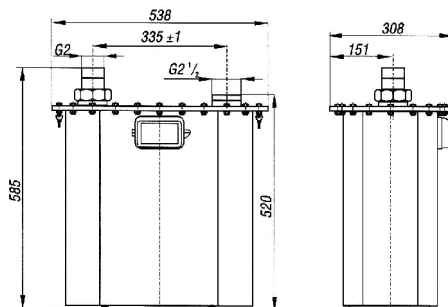

### Technical Data

Maximum flow rate:	40 m <sup>3</sup> /h
Minimum flow rate:	0,25 m <sup>3</sup> /h
Nominal flow rate:	25 m <sup>3</sup> /h
Cyclic volume:	20 dm <sup>3</sup>
Maximum working pressure:	0,2 bar
Index max indication volume:	99999,999m <sup>3</sup>
Starting flow rate:	20 dm <sup>3</sup> /h
Weight:	30 kg

### Pressure loss curves

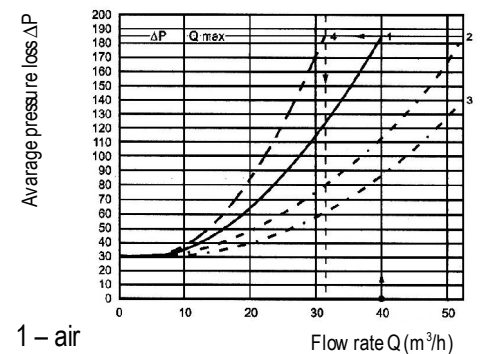

- 1 – air
- 2 – natural gas
- 3 – city gas
- 4 – propane-butane

METRIX SA • Piaskowa 3 • 83-110 Tczew, Poland  
tel. +48-58-53 09 200 • fax. +48-58-53 09 300  
<http://www.metrix.pl> • e-mail: [metrix@metrix.pl](mailto:metrix@metrix.pl)

**metrix**